

Countertop Lavatories

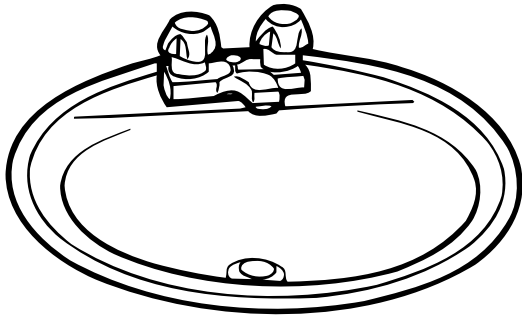
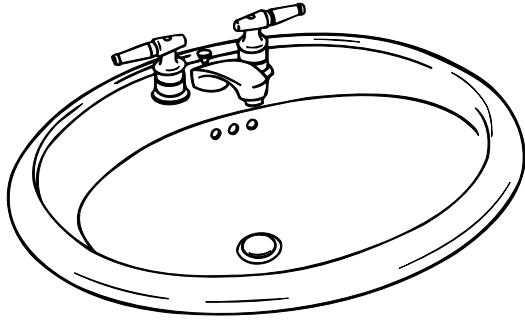

Instruction Guide

Caution:

Read all instructions carefully before starting the installation.

Save this manual for future reference.

EASY-TO-FOLLOW GUIDE FOR OLD LAVATORY REMOVAL, HOME INSTALLATION, AND MAINTENANCE.

HOW THIS GUIDE WILL HELP YOU

This guide describes everything you need to know about installing your new lavatory. It includes drawings and descriptions of its parts. Before you begin examine all parts and the drawings in this guide. If you read the instructions first, you will know what tools and materials you should have ready during installation.

Please handle all parts carefully to prevent scratches and breakage.

READ INSTRUCTIONS FIRST

BEFORE YOU BEGIN

If you are installing your countertop lavatory in a new or remodeled bathroom, make sure that you are in compliance with all local plumbing codes.

Rough-in information is included with your lavatory. This information will be helpful in placing the lavatory, water supply piping, shut-off valves, and drains in their proper positions.

REMOVING YOUR OLD LAVATORY

1. Turn off the water supply. This is done by closing the two shut-off valves located under the lavatory.

If there are no shut-off valves leading to the lavatory, you must turn off the water at the main valve. This is usually located in the basement, garage, or near the foundation on the outside of the house. It may also be near the water meter.

Check to be sure the water is off by turning on the faucet where you are working until the water stops flowing.

If you have shut off the main valves in a two-story house or greater, you should open another faucet on the same or lower level. Water will then drain from the entire line. This will help avoid spills. Be sure and close the faucets before you turn on the main valve again.

2. Disconnect the drain pipes. Take off as many sections as possible between the lavatory and the wall or floor to facilitate removal.

Place a basin under work area to catch any water that may still be in the drain.

3. Before removing anything else, check to see how the lavatory is supported. If the pipes in the wall are providing support for the lavatory, use care in removing the faucet connections. The lavatory may fall once the faucet is disconnected, so have a helper hold it up while you work.

Look under the lavatory to see if there are lugs holding it to the countertop. Do not remove the lugs until you have first braced the lavatory against falling.

You may be able to shore it up with pieces of lumber from below. Or you can rig the support as shown in Figure 1. This support consists of a strong wire or cord draped over a 2" x 4". Drop the wire through the drain and tie it to a block of wood. Twist the cord until the block of wood is snug against the tailpiece and provides a sure support for the lavatory. You may then unscrew the lugs and lower the lavatory by carefully untwisting the block of wood.

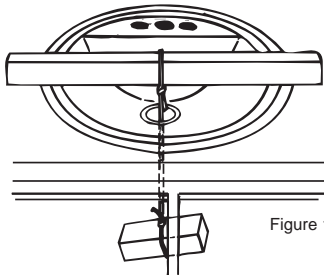

Figure 1

Detach the faucet from the shut-off valves by unscrewing the compression nut at the joints between the valves and the water supply tubes.

If the connection is corroded you may need to cut off the nut with a hacksaw. If there is no nut or shut-off valve, use a tube cutter or hacksaw to separate the faucet from the water supply tubes.

Keep the basin and sponge handy for water that remains in the pipe and faucet.

CAUTION: HANDLE WITH CARE

Your new lavatory is finished to an attractive high gloss. It may also be heavy and difficult to lift. To protect the finish and avoid possible damage before and after installation, please handle your lavatory with care. Place the lavatory on a thick bed of newspapers when working on it before installation. Also, line the inside of your lavatory with newspapers until the job is done.

INSTALLING YOUR NEW LAVATORY

NOTE: For self-rimming models follow steps 4, 5, 6, 8, 9, 11, 12, 14, 15, and 16; for models requiring a metal mounting frame (not provided) use steps 4, 7, 8, 9, 10, 11, 12, 13, 14, 15, and 16.

4. Once you have completed your bathroom countertop and determined the general location of your new lavatory, you are ready to cut the opening into which it will be placed.

TOOLS AND MATERIALS

You can determine which tools and materials are necessary by reading the complete installation instructions and examining the job you have to do. **These are normally needed:**

- sponge
- basin or pail
- tape measure
- flat blade screwdriver
- emery cloth
- hammer
- saber saw or keyhole saw
- drill
- adhesive sealant with rust inhibitor (included)
- a 3-foot piece of 2" x 4"
- heavy wire or cord (see step 3)
- cardboard, newspapers or a dropcloth

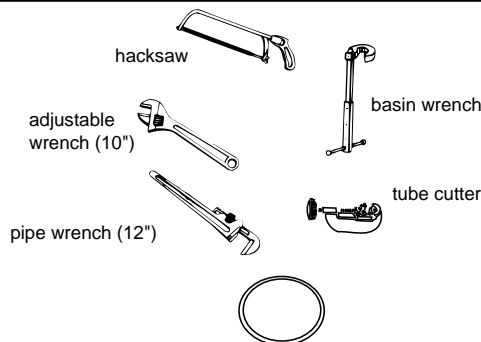

metal mounting frame with four screw clips (for non-self rimming lavatories only) provided by others. Be sure to select a frame that fits the dimensions of your lavatory

The materials listed below are optional. They are only necessary if existing materials are unusable:

Two shut-off valves with 1/2" I.P.S. outlet, optional (check house piping to determine valve inlet dimension)

1/2" I.P.S. hot and cold water supply tubes with compression nut and ferrule

Drain tail pipe, trap, and additional drain pipe as required

5. A template has been provided with your lavatory. This will help you cut an accurate opening. Place the template on the countertop.

Normally you will want your lavatory to be centered between the front edge of the counter and the backsplash. If your counter is more than 24" front to back, you may place the lavatory 2" to 3" from the front counter edge. The minimum distance from the lavatory to the front of the counter should be 1-1/2". Be sure to take the lavatory rim into account when making your measurements.

6. If your template is paper, fold it in half to create a centerline. If your template is cardboard, measure the length and width of the template to locate the center and draw a line. Move the template to the desired position and mark the location of the centerline. Measure the distance from the centerline to the nearest side wall or the end of the counter. Then measure the same distance from the side wall to locate the centerline at the back of the lavatory template. Now trace the outline of the

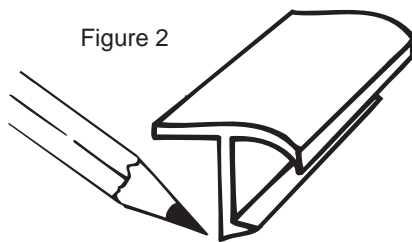

Figure 2

template accurately onto the countertop.

7. Measure across the metal mounting frame from side to side to locate its center. Mark this on the front of the frame. Move the frame to the desired position and mark the location of the centerline on the countertop. Measure the distance from the centerline to the nearest side wall or the end of the counter. Then measure the same distance from the side wall to locate the centerline at the back of the counter.

Line up the frame with the centerline and move it forward or back to its final location. Place a pencil against the outside of the frame as shown in Figure 2. Trace the outline of the frame accurately onto the countertop. The metal frame may have sharp edges. Handle it carefully.

8. Drill a hole in the line you have drawn. The hole should be large enough to take the blade of a key hole or saber saw. Carefully saw along the line. See Figure 3. Support the piece you are cutting out to prevent splitting when the cut is nearly complete.

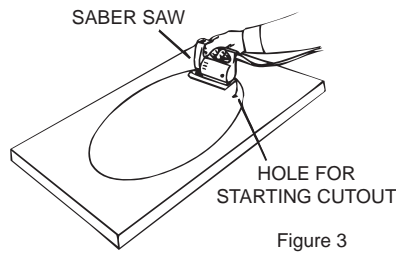

Figure 3

9. It is best to mount the pop-up drain and faucet before installing your lavatory. Be sure to place the lavatory on a thick bed of newspapers while working on it to prevent scratches.

Put in the pop-up drain first. Clean around the drain hole with a damp cloth to remove any dust or other particles that may interfere with a good seal. Remove the washers, nuts, and flange from the top of the pop-up. Coat the underside of the flange with sealant (included with your lavatory) and push it firmly into the drain opening. Following the manufacturer's instructions, tighten the flange firmly into place.

The excess sealant that oozes out around the flange should be cleaned off immediately with a damp cloth.

Next, attach the faucet according to the manufacturer's instructions. Most of the faucet installation is normally done with the lavatory upside down. When the faucet is securely in place, attach the new hot and cold water supply tubes to the faucet lines.

10. Put the metal mounting frame around the lavatory. Bend the tabs in the frame toward the lavatory, so that the frame is held to the edges all the way around. See Figure 4.

11. Clean the countertop surface around the

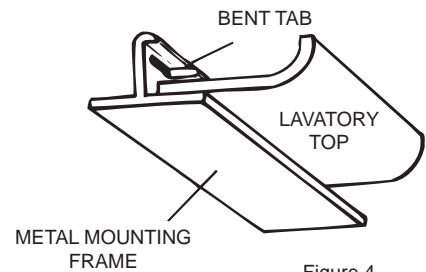

Figure 4

hole with a damp cloth. Apply a continuous bead of sealant (included with your lavatory) to the surface around the hole.

12. Carefully place the lavatory into the hole. A helper may be necessary to lift it into position. Align the lavatory in the hole, then push downward at intervals all around the edge. This will cause some of the sealant to ooze out. Wipe off the excess immediately with a damp cloth. It will be difficult to remove if allowed to dry.

13. Place the four screw clips around the lavatory so that the clips lock onto the metal mounting frame as shown in Figure 5. Tighten the screws on the clips evenly all around. Check the edges for additional sealant and remove it immediately with a damp cloth.

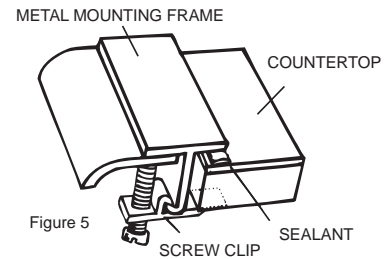

Figure 5

14. Connect the drain tailpiece to the bottom of the pop-up, then fasten the trap and drain extension to the wall stub-out in the wall. See Figure 6. You may use metal or plastic drain pipe and trap, following the directions provided by the manufacturer.

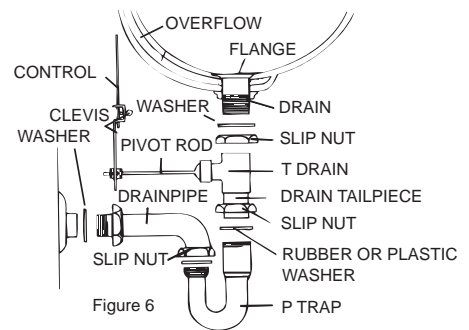

Figure 6

15. Use a tube cutter to trim the free ends of the hot and cold supply tubes to at least 1/4" longer than necessary to reach into the inlets of the shut-off valves. It is better to cut the tubes longer than needed, then trim them again. Remove any burrs or sharp edges with an emery cloth.

Join the hot and cold water supplies to the shut-off valves as instructed by the faucet manufacturer.

16. Turn on the main water supply then open the shut-off valves. Check all connections for leaks. A slight tightening of about 1/4 turn will normally stop any leaks.

CARE & CLEANING TIPS

Enameled Cast Iron

For general cleaning, use a mild, nonabrasive soap and warm water. Do not use abrasive cleaners. Such cleaners contain sand or silica and will eventually scratch the enamel finish. Stains, surface specks, and pot marks should be removed without scrubbing by applying a paste of such cleaners as BARKEEPERS FRIEND or ZUD.

Surface roughness or "gritty feel" in a new cast iron product can be eliminated by lightly rubbing with a dry #600 sandpaper.

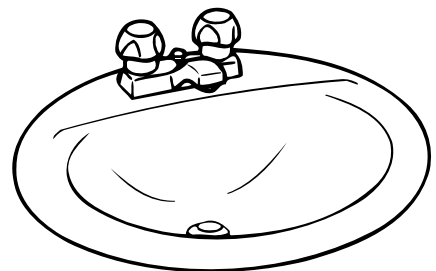
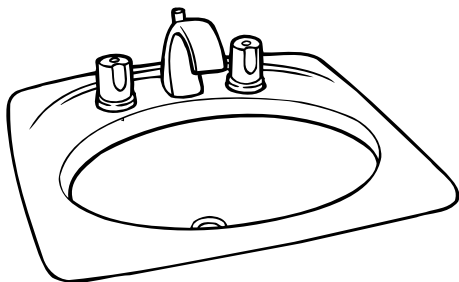
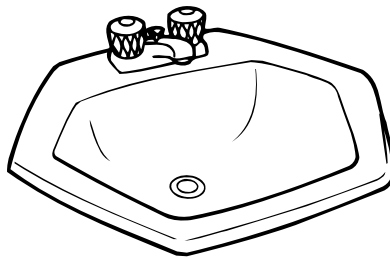

LIMITED WARRANTY

JACUZZI WHIRLPOOL BATH (“Jacuzzi Whirlpool Bath”, “we”, “us”, “our”), warrants to the original consumer/purchaser for the applicable warranty period set forth below, that the products we sell are free from defects in material and workmanship, except as otherwise indicated below.

| PRODUCTS | WARRANTY PERIOD |
|---|--|
| | (commences upon date originally installed for its intended purpose) |
| • All cast iron sink products with porcelain enamel finish. | Limited lifetime vessel warranty to the original consumer/purchaser only. The porcelain enamel finish is warranted for one (1) year. |
| • 1.6 gpf/6 ltr. china toilets. | Five (5) years. |
| • All other china products and kitchen sink accessories. | Two (2) years. |
| • All toilet seats. | One (1) year. |

ANY IMPLIED WARRANTY OF MERCHANTABILITY OR FITNESS FOR A PARTICULAR PURPOSE ON THESE PRODUCTS IS LIMITED IN DURATION TO THE WARRANTY PERIOD SPECIFIED ABOVE. SOME STATES DO NOT ALLOW LIMITATIONS ON HOW LONG AN IMPLIED WARRANTY LASTS, SO THE ABOVE LIMITATIONS MAY NOT APPLY TO YOU.

This limited warranty does not cover:

- (a) damage to any products based on or resulting from improper installation or repair, misuse or abuse (including but not limited to excessive operating conditions), or alteration or adjustment other than in conformity with our specifications or instructions, whether performed by a contractor, service company or yourself;
- (b) damages resulting from failure to reasonably clean, care for or maintain a product in accordance with our instructions/recommendations; or,
- (c) any products we sell that have been moved or removed from their original installation site.

If you believe that a product fails to meet the above limited warranty, you should notify us in writing prior to expiration of the applicable warranty period set forth above at the following address: **Jacuzzi Whirlpool Bath, PO Box 702168, Dallas, TX 75370-2168**. Notification should include a description of the product, model number and how the product fails to meet the above warranty. Upon receipt of a written claim under this limited warranty and evidence of the date of purchase or installation, and after inspection by an authorized Jacuzzi Whirlpool Bath representative, at our option and in our sole discretion, we will either repair or replace the product with a Jacuzzi Whirlpool Bath product of the same or similar type and size; provided, however, that we will not pay any costs (labor or otherwise) associated with either removing a previously installed product; installing a replacement product; or transportation or return of a product.

JACUZZI WHIRLPOOL BATH WILL NOT BE LIABLE FOR ANY OTHER LOSS OR EXPENSE(S) NOT SPECIFICALLY DESCRIBED ABOVE, AND DISCLAIMS ANY LIABILITY FOR CONSEQUENTIAL OR INCIDENTAL DAMAGES.

SOME STATES DO NOT ALLOW THE EXCLUSION OR LIMITATION OF INCIDENTAL OR CONSEQUENTIAL DAMAGES, SO THE ABOVE EXCLUSION MAY NOT APPLY TO YOU.

THIS WARRANTY GIVES YOU SPECIFIC LEGAL RIGHTS AND YOU MAY ALSO HAVE OTHER RIGHTS WHICH VARY FROM STATE TO STATE.

Free Manuals Download Website

<http://myh66.com>

<http://usermanuals.us>

<http://www.somanuals.com>

<http://www.4manuals.cc>

<http://www.manual-lib.com>

<http://www.404manual.com>

<http://www.luxmanual.com>

<http://aubethermostatmanual.com>

Golf course search by state

<http://golfingnear.com>

Email search by domain

<http://emailbydomain.com>

Auto manuals search

<http://auto.somanuals.com>

TV manuals search

<http://tv.somanuals.com>