



# EXECUTIVE™ DRAW POKER



MODEL 73048

For 1 player / Ages 8 and up

## INSTRUCTION MANUAL

NOT A GAMING DEVICE

P/N 82381500 Rev.A



### HOLD

Press **HOLD** to keep the card shown directly above each hold button. Press again to remove the hold on that card.

### HANDS/ODDS

Displays the current hand combination and compares the cards held to the actual odds of completing this particular hand. Pressing the button will advance to the next hand and the odds of completing that hand. (This can only be used in Poker Trainer mode.)

### SOUND

Press to turn **SOUND** on/off.

### TRAINER/DRAW POKER

Toggles between Poker Trainer and Regular Draw Poker.

### STRATEGY

Press **STRATEGY** to select Low, Medium, or High Risk Strategies. You can change strategies at any time. (This can only be used in Poker Trainer mode.)

### DEAL/DRAW/ON

- Press to **TURN ON** the game. The game turns itself off after sitting idle for one minute.
- Press and hold down this button for a **BET** of 1, 2, 3, 4 or 5 points. The cards are dealt when the button is released.
- After holding the cards you want to keep, press this button again to **DRAW** your replacement cards.

### BEST HAND

This game option recommends which cards to hold by flashing “**HOLD**” under them. Changing strategies can change the recommended cards to hold. (This can only be used in Poker Trainer mode.)

E

### MAX BET

This button can be pressed to automatically bet 5 points and deal the cards.

### RESET

Resets the game and clears the last score.

## USING POKER TRAINER MODE STRATEGY

The Poker Trainer offers 3 strategies that rank hands according to their “winning potential”. These strategies are:

**Low Return/Risk** — maximizes the total time played with a given number of points. However, it may not maximize your points won.

**Medium Return/Risk** — maximizes the total pay-back percentage with a given number of points. You may not play as long, but you may just hit it big!

**High Return/Risk** — maximizes your chances of building a Royal Flush. It may not, however, maximize your points or total playing time.

### BEST HAND

Completing a hand in Draw Poker is a challenge for every player. Often, players choose to hold the wrong cards. The **BEST HAND** feature will recommend the highest potential winning combination by flashing “**HOLD**” at the bottom of each card involved (If the current hand is not a “good” hand, **BEST HAND** will recommend to draw 5 new cards!). The **BEST HAND** feature is related to the 3 strategies. The game ranks over 70 potential hand combinations based on the current strategy. This “ranking” helps the game determine which cards to hold. The hand rankings are unique to each Return/Risk Strategy. The **BEST HAND** feature will help you to make the best decision for holding cards!

### ODDS

Draw Poker can also be played according to the odds. Holding a card or a group of cards can mathematically determine the odds of completing a hand. The odds are based upon the card, suit, type of hand, span between the cards, and probability of occurrence. Draw Poker odds are based upon “conditional probability”, unlike lotteries which are pure “mathematical probability”. The Poker Trainer will show you the odds of completing any given hand, based upon the cards held. However, playing the “odds” is a good way to place your bets.

## DRAW POKER HINTS

1. Always keep a Low Pair.
2. Learn the different hand combinations.
3. Never keep a “Kicker”. A “Kicker” is an additional card held in addition to a single pair.
4. Always bet the maximum amount of points.
5. Know your odds of completing a hand!
6. Practice and test your skill by switching from Draw Poker to Poker Trainer!

## PLAYING THE GAME

- Turn on the game by pressing the **DEAL/DRAW/ON** button.
- Choose whether you want to play with or without the Poker Trainer mode in effect. If you are playing in Poker Trainer mode, choose the strategy you wish to use.
- Press the **DEAL/DRAW/ON** or **MAX BET** buttons to bet and deal your first set of cards.
- Select the cards you wish to hold by using the **HOLD** buttons. If you want to know the odds of achieving a particular hand when holding certain cards, press the **HOLD** buttons under those cards and press **HANDS/ODDS**. If you are not sure what to hold, press **BEST HAND** and the computer will show you what to hold.
- After holding the cards you want, press **DEAL/DRAW/ON** again to receive your replacement cards. If you have achieved one of the winning hands listed on the front of the game, your point total will automatically increase.

## BATTERY INSTALLATION

This game is powered by two (2) AAA (LR03) batteries. For extra long battery life, use alkaline batteries.

1. Press a coin (or similar object) into the slot next to the battery compartment door. At the same time, slide the battery compartment door out to reveal the battery compartment.
2. Insert two fresh alkaline batteries with the negative (-) ends against the springs.
3. Replace the battery compartment cover.

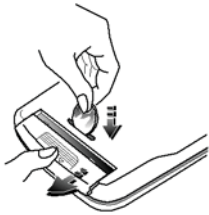

## CAUTION

- As with all small batteries, the batteries used with this game should be kept away from small children who might still put things in their mouths. If a battery is swallowed, consult a physician immediately.
- Be sure you insert the battery correctly and always follow the game and battery manufacturer's instructions.
- Do not dispose of batteries in fire.
- Batteries might leak if improperly installed, or exploded if recharged, disassembled or heated.
- When you are playing this product in an environment where it may receive an electrostatic discharge (cold and dry), it may malfunction and need to be manually reset.

## MAINTENANCE:

- Handle this game carefully.
- Store this game away from dusty or dirty areas.
- Keep this game away from moisture or extreme temperature.
- Do not disassemble this game. If a problem occurs, remove and replace the batteries to reset the computer or try new batteries. If problems persist, consult the Warranty information located at the end of this Instruction Manual.
- Use only the recommended battery type.
- Do not mix old and new batteries.
- Do not mix alkaline, standard (carbon-zinc) or rechargeable (nickel-cadmium) batteries.
- Do not use rechargeable batteries.
- Do not attempt to recharge non-rechargeable batteries.
- Remove any exhausted batteries from this product.
- Do not short-circuit the supply terminals.
- Insert batteries with the correct polarity.

## 90-DAY LIMITED WARRANTY

**(This product warranty is valid in the United States and Canada only)**

Radica Games Limited warrants this product for a period of 90 days from the original purchase date under normal use against defective workmanship and materials (batteries excluded). This warranty does not cover damage resulting from accident, unreasonable use, negligence, improper service or other causes not arising out of defects in material or workmanship. Radica Games Limited will not be liable for any costs incurred due to loss of use of this product or other incidental or consequential costs, expenses or damages incurred by the purchaser. Some states do not allow the exclusion or limitation of incidental or consequential damages, so the above limitations may not apply to you. This warranty gives you specific legal rights and you may also have other legal rights, which vary from state to state.

During this 90-day warranty period, the game will either be repaired or replaced (at our option) without charge to the purchaser when returned prepaid with proof of date of purchase to: **Radica USA, Ltd., 13628-A Beta Road, Dallas, Texas 75244, USA.** Please remove the batteries and wrap the unit carefully before shipping. Please include a brief description of the problem along with your return address and mail it postage prepaid.

**IMPORTANT:** Before returning the unit for repair, test it with fresh alkaline batteries. Even new batteries may be defective or weak and low battery power is a frequent cause of unsatisfactory operation.



**RADICA:®**  
 EXECUTIVE DRAW POKER IS A TRADEMARK  
 OF RADICA GAMES LTD.  
 © 2003 RADICA GAMES LTD.  
 PRODUCT SHAPE™  
 ALL RIGHTS RESERVED

<i><b>Draw Poker Winning Hands:</b></i>	<i><b>Points:</b></i>	<i><b>Example:</b></i>					
<b>Royal Flush</b>	<b>5000</b> .....	<table border="1"> <tr> <td>A ♣</td> <td>K ♣</td> <td>Q ♣</td> <td>J ♣</td> <td>10 ♣</td> </tr> </table>	A ♣	K ♣	Q ♣	J ♣	10 ♣
A ♣	K ♣	Q ♣	J ♣	10 ♣			
<b>Straight Flush</b>	<b>250</b> .....	<table border="1"> <tr> <td>9 ♠</td> <td>8 ♠</td> <td>7 ♠</td> <td>6 ♠</td> <td>5 ♠</td> </tr> </table>	9 ♠	8 ♠	7 ♠	6 ♠	5 ♠
9 ♠	8 ♠	7 ♠	6 ♠	5 ♠			
<b>4 of a Kind</b>	<b>125</b> .....	<table border="1"> <tr> <td>A ♣</td> <td>A ♦</td> <td>A ♠</td> <td>A ♥</td> <td>ANY</td> </tr> </table>	A ♣	A ♦	A ♠	A ♥	ANY
A ♣	A ♦	A ♠	A ♥	ANY			
<b>Full House</b>	<b>40</b> .....	<table border="1"> <tr> <td>7 ♠</td> <td>7 ♣</td> <td>7 ♦</td> <td>4 ♣</td> <td>4 ♦</td> </tr> </table>	7 ♠	7 ♣	7 ♦	4 ♣	4 ♦
7 ♠	7 ♣	7 ♦	4 ♣	4 ♦			
<b>Flush</b>	<b>25</b> .....	<table border="1"> <tr> <td>J ♣</td> <td>9 ♣</td> <td>5 ♣</td> <td>4 ♣</td> <td>2 ♣</td> </tr> </table>	J ♣	9 ♣	5 ♣	4 ♣	2 ♣
J ♣	9 ♣	5 ♣	4 ♣	2 ♣			
<b>Straight</b>	<b>20</b> .....	<table border="1"> <tr> <td>10 ♠</td> <td>9 ♣</td> <td>8 ♥</td> <td>7 ♦</td> <td>6 ♣</td> </tr> </table>	10 ♠	9 ♣	8 ♥	7 ♦	6 ♣
10 ♠	9 ♣	8 ♥	7 ♦	6 ♣			
<b>3 of a Kind</b>	<b>15</b> .....	<table border="1"> <tr> <td>A ♦</td> <td>A ♠</td> <td>A ♣</td> <td>ANY</td> <td>ANY</td> </tr> </table>	A ♦	A ♠	A ♣	ANY	ANY
A ♦	A ♠	A ♣	ANY	ANY			
<b>Two Pair</b>	<b>10</b> .....	<table border="1"> <tr> <td>9 ♣</td> <td>9 ♥</td> <td>7 ♠</td> <td>7 ♦</td> <td>ANY</td> </tr> </table>	9 ♣	9 ♥	7 ♠	7 ♦	ANY
9 ♣	9 ♥	7 ♠	7 ♦	ANY			
<b>Pair of Jacks or Better</b>	<b>5</b> .....	<table border="1"> <tr> <td>Q ♣</td> <td>Q ♦</td> <td>ANY</td> <td>ANY</td> <td>ANY</td> </tr> </table>	Q ♣	Q ♦	ANY	ANY	ANY
Q ♣	Q ♦	ANY	ANY	ANY			

## Free Manuals Download Website

<http://myh66.com>

<http://usermanuals.us>

<http://www.somanuals.com>

<http://www.4manuals.cc>

<http://www.manual-lib.com>

<http://www.404manual.com>

<http://www.luxmanual.com>

<http://aubethermostatmanual.com>

Golf course search by state

<http://golfingnear.com>

Email search by domain

<http://emailbydomain.com>

Auto manuals search

<http://auto.somanuals.com>

TV manuals search

<http://tv.somanuals.com>