

**REMINGTON®**

## Use and Care Guide

*The  
cleaning  
system  
shaver  
with  
Titanium-  
coated  
blades!*

**TITANIUM**  
**SMART SYSTEM**



MS-5500  
MS-5700

# IMPORTANT SAFETY INSTRUCTIONS

When using an electrical appliance, basic precautions should always be observed, including the following. Read all instructions before using this appliance.

## DANGER

To reduce the risk of electric shock:

- Do not reach for an appliance that has fallen into water. Unplug it immediately.
- Do not use while bathing or in the shower.
- Do not place or drop into water or other liquid.
- Do not place or store this appliance where it can fall or be pulled into a tub or sink.
- Except when charging, always unplug this appliance from the electrical outlet immediately after using.
- Unplug this appliance before cleaning it.

## WARNING

To reduce the risk of burns, fire, electric shock or injury to persons:

- This appliance is for household use only.

- An appliance should never be left unattended when it's plugged in, except when charging a rechargeable appliance.
- Close supervision is necessary when this appliance is used by, on, or near children or invalids.
- Use this appliance only for its intended use as described in this manual. Do not use attachments not recommended by Remington.
- Keep the cord away from heated surfaces.
- Never operate this appliance if it has a damaged cord or plug, if it is not working properly, if it has been dropped or damaged, or if it has been dropped into water. If any of these things happen, return the appliance to an authorized service center for examination and repair.
- Never drop or insert any object into any of the appliance's openings.
- Do not use outdoors or operate where aerosol (spray) products are being used, or where oxygen is being administered.
- Always store this appliance and cord in a moisture-free area. Do not store it in temperatures exceeding 140°F (60°C).

- Do not plug or unplug this appliance when your hands are wet.
- Do not use an extension cord or a voltage converter with this appliance.
- Do not wrap the cord around the appliance.
- Always attach the plug to the appliance, then to the outlet. To disconnect, turn all controls to OFF, then remove plug from outlet. Detach removable power cords from appliances for storage.
- Do not use this appliance with a damaged or broken screen or cutters, as injury may occur.
- Shavers are for use on facial hair only. They should not be used for shaving the hair on your head.
- Use the cleaning base only on a level surface.
- Unplug the cleaning base before filling. Fill reservoir with Remington® cleaning solution only. Do not overfill.

# SAVE THESE INSTRUCTIONS

## Contents

English .....	4
Spanish .....	17
French .....	33

## Product Features

### Shaver Parts

- (A) Screen & cutter assembly
- (B) Pop-up mini-foil
- (C) Mini-foil push tab
- (D) Beard-lifting fins
- (E) 3-position trimmer
- (F) Trimmer push tab
- (G) ON/OFF button
- (H) POWER RESERVE button (one on each side)
- (I) Head release button
- (J) Charging indicator (MS-5500 only)
- (K) LED display (MS-5700 only)
- (L) Head guard
- (M) Cleaning brush
- (N) Travel pouch

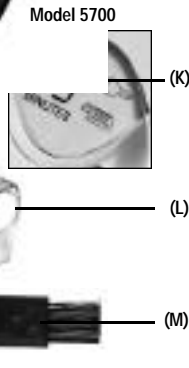
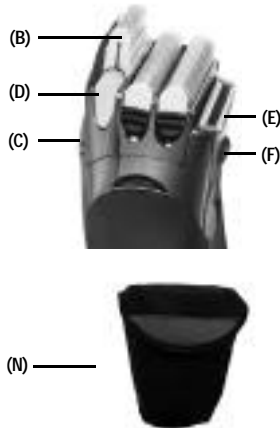
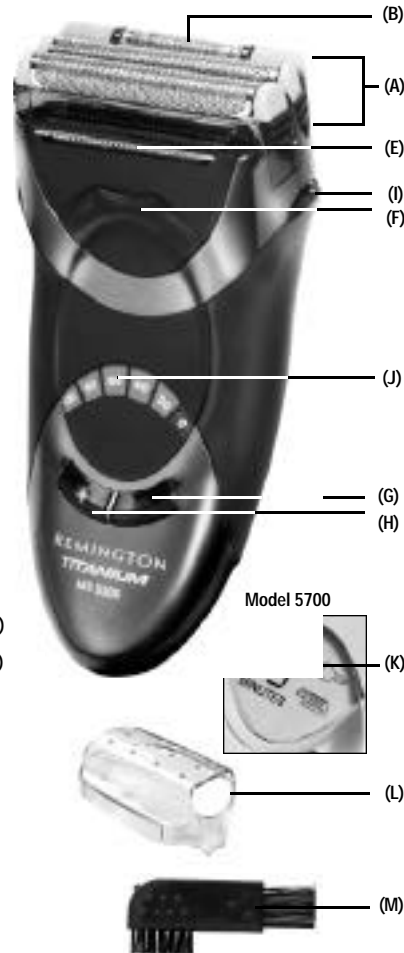

4

## Titanium MicroScreen®

Congratulations on your purchase of a premium Remington® shaver.

Titanium MicroScreen® is the only cleaning system shaver with Titanium-coated blades!

### Which model is yours?

	Power system	Washable	Quick charge	Run time	Power reserve	Complete battery gauge	Liquid crystal display	Worldwide voltage
MS-5500	Cord/cordless	X	X	55 min	5 min	X		X
MS-5700	Cord/cordless	X	X	55 min	5 min		X	X

### Quick Charge

Quick Charge shavers fully recharge in one hour. Five minutes gives you enough power for a single shave.

### Power Reserve

MicroScreen® shavers will run 55 minutes on a single charge. If those 55 minutes end in the middle of a shave, you can push the Power Reserve button to get an extra 5 minutes of power. While using the Power Reserve, the plus sign on the Power Reserve button will glow yellow. The Power Reserve button will not activate the shaver if there is any charge left on the battery.

### Complete Battery Gauge

When the shaver is on, the battery gauge displays the amount of charge remaining, in 20% increments. When only 20% of the charge remains, the red recharge warning light illuminates. The indicator lights turn off when the shaver is

off. You can find out how much charge is left on your shaver by pushing the Power Reserve button while the shaver is off.

### LCD Indicator

- The LCD numeric indicator shows how many minutes are left on the charge.
- When the LCD's plug outline fills in, it means you have approximately 5 to 6 minutes of shaving time left.
- When the LCD's screen outline fills in, it means it's time to replace the shaver's screens and cutters.

### Worldwide Voltage

The Smart Shaver features worldwide automatic dual voltage conversion, providing AC current between 100-240 volts AC, 50-60 Hz. Just plug it in to the local outlet (you may need an adapter plug) and use as usual. Your shaver will convert automatically to the local current requirements.

5

## Product Features (continued)

### Smart Cleaner

The Remington® Cleaning System has been developed to automatically clean and charge your shaver.

The Remington® Cleaning System has been developed to automatically clean and charge your shaver. It also serves as a storage unit. For peak performance of your shaver, clean it daily by pushing the CLEAN button.

During the automated cleaning process, the shaver is switched on and off at intervals to obtain best cleaning results. Since the specially formulated cleaning fluid also contains a small amount of oil, the cleaning procedure also fulfills the lubrication needs of your shaver.

**NOTE:** Remington recommends cleaning your shaver daily for optimum shaving performance.

**NOTE:** With daily cleaning, the solution will last about 4 weeks. The cleaning solution, if not used daily, will last longer. Normal evaporation will occur even when the unit is not being used. In hot, humid weather, solution may evaporate more rapidly.

### Cleaning Cautions

- Use only the power supply cord supplied with this product.
- In order to avoid any leakage of the cleaning fluid, place the cleaning base on a flat table surface. Be careful not to tip, move suddenly, or transport in any way if the base is filled with the cleaning fluid.
- Do not place the cleaning base in a cabinet or any other enclosed area unless the solution is empty. Do not store it over radiators, nor place it on polished, lacquered, or any other surface that is susceptible to damage by isopropyl alcohol. Always operate and store it in a well ventilated area.
- To avoid evaporation, do not expose cleaning solution to direct sunlight.
- The cleaning base contains highly flammable liquid. Keep it away from sources of ignition. No smoking. Keep out of reach of children. Discard cleaning solution bottle after contents have been poured into the cleaning base.
- When cleaning the shaver, its clear plastic head guard must be removed.
- Do not block fan area.

### Cleaning System Parts

- (A) Shaver
- (B) Cleaning light (yellow)
- (C) Charging light (green)
- (D) Replace solution indicator light (red)
- (E) Cleaning button
- (F) Latch buttons
- (G) Cleaning base
- (H) Cleaning solution bottle
- (I) Filter
- (J) Safety power plug

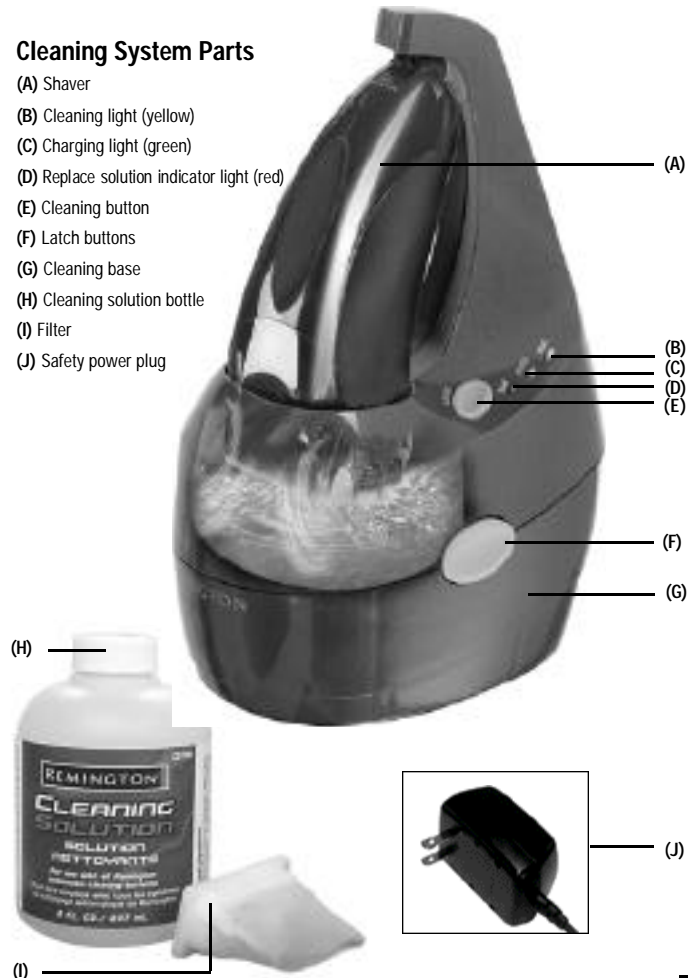

## How to Use

### Charging

Before using your shaver for the first time, put it on charge for 24 hours.

### Preparing the System

#### Cleaning solution:

1. Press the latch buttons on the sides of the cleaning base and lift the upper portion off the unit. You will need to keep the buttons pressed in as you move the upper portion away from the base. The cleaning solution tank is in the unit's bottom portion.

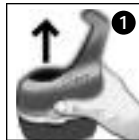

2. Remove the filter from the tank and set aside.



3. Pour the bottle of cleaning solution into the base of the unit through the opening where the filter was removed. Fill tank to the bottom of the fill tab.



4. Place the filter back into its original position.

**NOTE:** It is important to make sure the filter is in place. The filter collects hair clippings and debris, and should be replaced along with the solution. Failure to do so will permanently clog the system rendering it inoperable.

- Replace the top portion of the cleaning base by lining up the three tall posts with the three holes in the tank. Push the top portion down until the two latches click into place.
- You can dispose of the bottle and cap with your normal trash, or recycle where local ordinances apply.

### Operating the Charging/Cleaning System

Plug the power cord into the cleaning base and then into an electrical outlet.

Place the shaver into the unit, head side down, and slide its "tail" toward the "neck" of the base until it clicks into place.

#### Charging

Your shaver automatically begins to recharge as soon as it clicks into place in the cleaning base. While it is charging, the green indicator light will flash; when it is fully charged the green light will stop blinking and glow steadily.

#### Cleaning

To activate cleaning mode, simply press the CLEAN button on the cleaning base. The yellow indicator light flashes through the entire cleaning cycle, which lasts approximately 25 minutes. When the cleaning cycle has been completed, the yellow light will stop blinking and glow steadily. The unit then returns to charging mode.

! Wait until the cleaning cycle has finished before removing the shaver from the base. If the shaver is removed during the cleaning cycle it will be covered with cleaning solution and be unusable.

#### Solution levels

The cleaning solution will slowly evaporate with use. When the solution levels get low, the red replacement indicator light will begin to flash. This means you have enough cleaning solution left for approximately 5 more cleanings. If the red light stops blinking and glows steadily, the unit will not operate until the solution and filter have been replaced.

#### Replacing the Filter and Solution

Only the Remington® special cleaning solution and filter can be used with the Smart System. The cleaning solution contains a high percentage of alcohol and a special oil that lubricates your shaver each time it is cleaned. The filter is specially designed to collect hair debris yet allow for the system to clean your shaver.

To refill the cleaning solution and replace the filter, follow the steps for "Preparing the System" above. But before replacing the upper portion of the unit, rinse out the tank with fresh water and allow it to air dry to remove any sediment.

Wipe off the unit periodically with a damp cloth and remove any hair debris that has collected where the shaver sits.

! To avoid damage to the cleaning system, use only Remington special cleaning solution.

The Remington® replacement solution and filter is model #CC-100. U.S. residents: To order, contact us at 800-736-4648, [www.remington-products.com](http://www.remington-products.com), or visit your local retailer.

Canadian residents: For shaver accessories, please call 800-268-0425.

### To Charge Your Shaver

The MS-5500 and MS-5700 can also be recharged by plugging it into the cord directly.

- Use only the charging adapter supplied with the shaver.
- Make sure your shaver is turned off.
- Connect the cord to the shaver, then plug the charging adapter into the electrical outlet. A charging indicator light will come on.
- Your shaver cannot be overcharged, so you can leave it plugged in and charging between shaves.
- To preserve the life of the batteries, let them fully run out every six months, then recharge them for a full 24 hours.
- Cord/cordless rechargeable shavers can run directly off the cord if necessary. They will not recharge while you are shaving, so after shaving with the cord, turn the unit off and set it aside to charge. Cord/cordless shavers should not be used strictly as cord-operated shavers, as continued cord-only use will result in reduction of battery life.
- Quick Charge provides up to three weeks of shaving after a one-hour charge, or a single shave after a five-minute charge.
- If your shaver's charge runs out in the middle of a shave, you can push the power reserve button to get an extra 5 minutes of power.

**NOTE:** If your shaver battery is completely discharged or the shaver has not been used for a long time, the shaver may not start when operated using the cord. If this happens, charge the shaver for approximately five minutes before shaving.

## How to Use (continued)

### Removing the Headguard

Before operating your shaver, remove the head-guard, which protects the screen and cutter assembly. Simply push up from the front or the back until it pops off.



! Always keep the protective head guard on the shaver head and keep the trimmer in the OFF position when the shaver is out of the cleaning base and not in use.

### Operating the Trimmer

Your shaver is equipped with a 3-position trimmer. Use the trimmer push tab to extend or retract the trimmer.



1. Completely retracted (down), the trimmer is out of the way and off, for when you want to use the screens alone. Press the trimmer down with your thumb to get it into this position.
2. In the middle position, the trimmer works with the screens, cutting the longer, hard-to-shave hairs so the screens can get in extra close. Slide the trimmer into the position level with the foils.
3. Fully extended (up), the trimmer can be used to trim your sideburns and mustache. Slide the trimmer into the top position, above the foils.

### Operating the Pop-up Mini-foil

Your shaver is equipped with a 2-position mini-foil. Use the mini-foil push tab to extend or retract the mini foil.

1. Completely retracted (down), the mini-foil works with the 2 large screens to provide a close and comfortable shave.
2. Fully extended (up), the mini-foil can be used to provide a close shave for small or difficult-to-reach areas, for a detailed look.

! Do NOT retract the mini-foil by pressing down directly on the screen. This could permanently damage the screen.

## Usage Tips

### Adjusting to your new shaver

As with every shaver, your shave will improve over time. So allow about three weeks to develop an effective shaving style and for your beard to adjust to the new shaver. The adaptation period may take a little longer if your skin is sensitive, or if you alternate between shaving methods.

To help smooth the transition to your new shaver, Remington has applied a special lubricant to the shaver's screens and cutters. The lubricant looks like fine, white or gray powder, and disappears with use.

### Before you begin

- Wait at least 15 minutes after getting up before shaving, to ensure your face is free of puffiness that may be present from sleeping.
- Make sure your face is clean and dry before starting.
- Always use a clean, dry shaver.

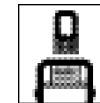
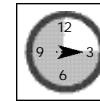

### To shave

Push the ON/OFF button. Hold the shaver so both screens touch your face at the same time. This allows the shaver to work the way it was designed for the closest shave and minimum wear. Avoid holding the shaver at an angle so only one screen touches the skin at a time. This will distort the screen and could cause skin irritation.



Shave with short, circular strokes. Use your free hand to stretch your skin.



This encourages your whiskers to stand out, making it easier for them to enter the cutting chamber.

Never press hard. Pressing only flattens your whiskers, making it harder for them to enter the cutting chamber. It will also wear out the cutting surface more quickly.

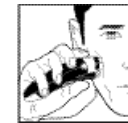

### For an even better shave...

Remington® Pre-Shave Powder Stick (SP-5) or the Pre-Shave Lotion with Aloe (SP-6) can help maximize your shaver's performance. Just rub either product over your beard. Both absorb moisture and facial oils, helping set up the hairs so they enter the cutting chamber more easily. They make shaving quicker and more comfortable.

## Maintenance

### Replacing Cutters and Screens

To prevent inadvertent damage to the cutters and screens, do not attempt to remove them from the head assembly unless you are replacing them. Removal instructions are included with the cutter and screen replacement packages.

#### To replace a cutter assembly that is removed unintentionally:

1. Hold the cutter in the middle. The blades will not cut your fingers, so no special handling techniques are necessary.
2. Align the cutter so the little bar on the bottom meets the opening in the clip.
3. Press down on the center of the cutter until it snaps into place. Do not push down on the ends of the cutter, as you may bend the cutter, reducing its ability to cut cleanly.
4. Do not separate the cutter's blades from the plastic pieces they are attached to, as this may damage the assembly.

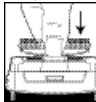

#### When is it time to replace your screens and cutters?

Because they are subject to daily use, the cutters and screens of your shaver will wear and eventually require replacement to maintain a close, comfortable shave. It is very important to replace your screens and cutters when necessary to ensure a close, comfortable shave without irritation.

Depending on your shaving technique and habits, the screens will usually last 6 months; the cutters, 12 months. If you are replacing the cutters, it's a good idea to replace the screens at the same time.

Here are some signs that your screens and cutters need replacing:

**Irritation:** As screens get worn, you may notice that your skin feels more sensitive after a shave, particularly when you apply aftershave.

**Pulling:** As cutters wear, your shave may not feel as close and you may feel your shaver is pulling at your whiskers.

**Wear-through:** You may notice that the cutters have worn through the screens.

The replacement part for this shaver is model SP-95 (screens) and SP-96 (screens and cutters).

U.S. residents:  
To order shaver accessories call 800-736-4648, visit [www.remington-products.com](http://www.remington-products.com), or visit your local retailer.

Canadian residents:  
To order shaver accessories, please call 800-268-0425 or visit [www.remington-products.com](http://www.remington-products.com)

## Disposal

### Battery Removal

When your rechargeable shaver reaches the end of its useful life, the batteries must be removed from the shaver and be recycled or disposed of properly in accordance with your state and local requirements. If this is not required by law, you may elect to dispose of the shaver without removing the batteries.

**CAUTION: DO NOT PUT IN FIRE OR MUTILATE YOUR BATTERIES WHEN DISPOSING AS THEY MAY BURST OR RELEASE TOXIC MATERIALS. DO NOT SHORT CIRCUIT AS IT MAY CAUSE BURNS. DISPOSE PROPERLY IN ACCORDANCE WITH YOUR LOCAL AND STATE REQUIREMENTS.**

! Make sure shaver is unplugged before you begin, to avoid a possible electric shock hazard.

1. Press the two side buttons and pull off the shaver head assembly.

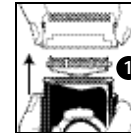

2. Remove the 4 outer screws from inside the shaver head. Loosen the top assembly from the body.

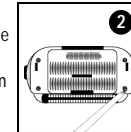

3. Remove the screw from the back of the shaver near the power port.

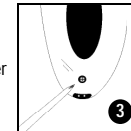

4. Remove the two side panels to allow removal of 2 more screws.

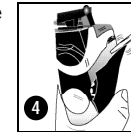

5. Pry off the back cover of the shaver, starting at the gap below the shaver socket.

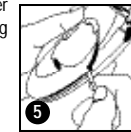

6. Cut or break the wires attached to the battery on the right.
7. Pry both of the batteries loose from the foam adhesive tape on the PCB.
8. Cut or break the wires connecting the batteries to the PC board.

## Warranty

### Warranty Service

In the U.S. and Canada, service is provided by authorized service dealers. For the address of your nearest authorized service dealer, contact us at 800-736-4648 (in U.S.), 800-268-0425 (in Canada), visit our website at [www.remington-products.com](http://www.remington-products.com) or consult your local Yellow Pages under "Shaver-Electric-Repair."

KEEP ORIGINAL SALES RECEIPT AS PROOF OF PURCHASE FOR WARRANTY PURPOSES.

#### Questions or comments:

Call 800-736-4648 in U.S. or 800-268-0425 in Canada.  
Or visit [www.remington-products.com](http://www.remington-products.com)

100-240 VAC 50/60 Hz

Remington, the Microscreen design, and Shaver Saver are trademarks of Rayovac Corporation.  
© 2004 R.C.

Job #S04-025 5/04 Part No.14431  
U.S. Patent D447,284 and Patents Pending.  
Canadian Patent 92,979 and Patents Pending.



Rayovac Corporation  
800-736-4648

MADE IN CHINA

Rayovac Canada Ltd.  
800-268-0425

## Performance Guarantee

### Performance Guarantee

#### Rayovac Money-Back Offer

If within 30 days after you have purchased your Remington brand product, you are not satisfied with it and would like a refund, just return it, together with the sales receipt, to the retailer from whom it was purchased. Rayovac will reimburse all retailers who accept such appliances within 30 days from date of purchase. If you have any questions regarding this money-back guarantee, please call 800-736-4648 in the U.S. or 800-268-0425 in Canada.

#### Full Two-Year Warranty

Rayovac warrants that this product is free from defect in material and workmanship for two years after its original purchase date—except for damage as specified below and these parts meant to be replaced during regular maintenance:

- SHAVERS: head assembly
- SMART SYSTEM: filter

If the product should become defective within the warranty period, Rayovac will repair it or elect to replace it free of charge. We will return your product, shipping charges prepaid, if you do the following within two years of the purchase date:

1. Return the complete product in person or by mail, postage paid, to an authorized service dealer.
2. Include the original purchase receipt with the product.
3. Include a description of the problem or defect.
4. Do not return the product to the store that sold it to you.

This warranty does not cover products damaged by the following:

- Accident, misuse, abuse or alteration of it
  - Servicing by unauthorized persons
  - Use with unauthorized accessories
  - Connecting it to incorrect current and voltage
  - Any other conditions beyond our control
- No responsibility, obligations, or liability is assumed for the installation or maintenance of this product.

RAYOVAC SHALL NOT BE RESPONSIBLE FOR ANY INCIDENTAL, SPECIAL OR CONSEQUENTIAL DAMAGES RESULTING FROM THE USE OF THIS PRODUCT. **USE OF NON-REMINGTON® CLEANING SOLUTION VOIDS THE WARRANTY.** ALL IMPLIED WARRANTIES INCLUDING BUT NOT LIMITED TO IMPLIED WARRANTIES OF FITNESS AND MERCHANTABILITY, ARE LIMITED IN DURATION TO TWO YEARS FROM DATE OF ORIGINAL PURCHASE.

This warranty gives you specific legal rights, and you may also have other rights that vary from state to state or province to province. Some states do not allow the exclusion or limitation of incidental or consequential damages, or limitations on how long an implied warranty lasts, so the above limitations and exclusions may not apply to you.

U.S. residents:  
To order shaver accessories contact us at 800-736-4648, visit us at [www.remington-products.com](http://www.remington-products.com), or visit your local retailer.

Canadian residents:  
To order shaver accessories, please call 800-268-0425 or visit us at [www.remington-products.com](http://www.remington-products.com)



## Free Manuals Download Website

<http://myh66.com>

<http://usermanuals.us>

<http://www.somanuals.com>

<http://www.4manuals.cc>

<http://www.manual-lib.com>

<http://www.404manual.com>

<http://www.luxmanual.com>

<http://aubethermostatmanual.com>

Golf course search by state

<http://golfingnear.com>

Email search by domain

<http://emailbydomain.com>

Auto manuals search

<http://auto.somanuals.com>

TV manuals search

<http://tv.somanuals.com>