

instructions

DeLonghi



BLENDER

KF8110J



Living innovation

Description of Appliance

The following terms are used throughout the instruction manual

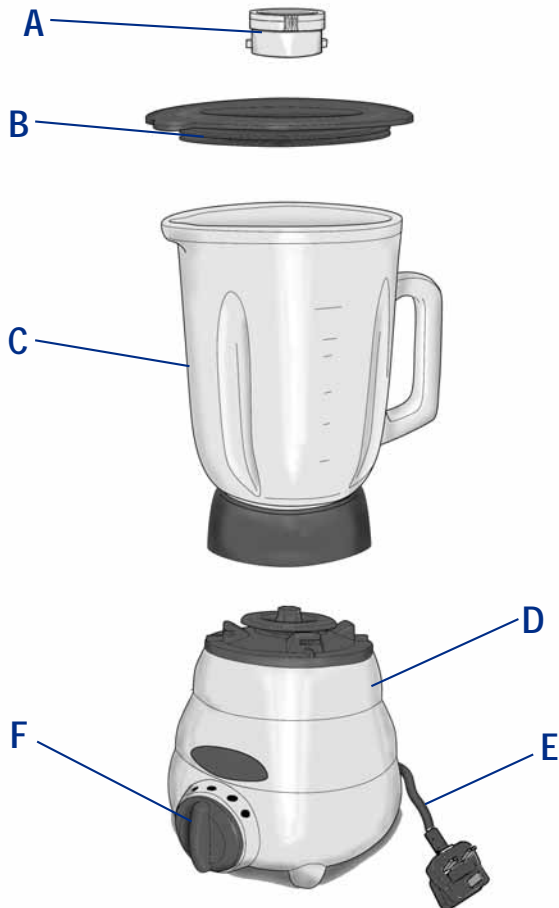

COMPONENTS

- A Filler cap
- B Lid
- C Glass goblet and blade assembly
- D Motor body
- E Power cord and plug
- F On/Speed control



Blender
KF8110J

IMPORTANT WARNINGS

Read these instructions carefully

When using electrical appliances, there are precautions that need to be followed; these include the following:

- Make sure that the voltage of your appliance corresponds to that of your mains power supply.
- Do not leave the appliance unattended when connected to the mains power; disconnect it after each use.
- Do not leave the appliance exposed to the weather (rain, sun, etc.)
- **NEVER LEAVE THE APPLIANCE WITHIN THE REACH OF CHILDREN**
- Never leave the appliance on or near to sources of heat.
- Make sure that the power cord does not come into contact with any hot surfaces.
- **NEVER PLACE THE MOTOR BODY, PLUG, OR POWER CORD IN WATER OR OTHER LIQUIDS - WIPE CLEAN USING A DAMP CLOTH ONLY.**
- **NEVER TOUCH MOVING PARTS.**
- Do not operate the appliance when empty.
- Never use the appliance to chop excessively tough foods.
- Always use the appliance on a flat surface.
- Don't transport the blender with the glass cup assembled; don't use the glass cup handle to transport the blender.
- Never use the appliance if the power cord or plug are damaged or if the appliance is faulty; in this case, take it to your nearest Authorised Assistance Centre.
- The use of extension leads not authorised by the appliance manufacturer may cause damage or accidents.
- Never use the appliance if the blade is damaged.
- **Never place your hands inside the container when the appliance is connected to the mains power.**
- This appliance has been designed for DOMESTIC USE ONLY and may not be used for commercial or industrial purposes.

WARNING

PREPARE THE CONTAINER WITH THE ITEMS TO BE BLENDED AND FIT IT TO THE MOTOR BODY BEFORE INSERTING THE PLUG.

- This appliance complies with the EEC 89/336 Directive with regard to electromagnetic compatibility.
- The blades are very sharp. Take care when cleaning.
- In the event that you decide to dispose of the appliance, we advise you to make it inoperative by cutting off the power cord. We also recommend that any parts that could be dangerous be rendered harmless, especially for children, who may play with the appliance or its parts.

- Packaging must never be left within the reach of children since it is potentially dangerous.
- **To prevent accidents or damage to the appliance, always keep your hands and cooking utensils away from the blades and moving parts.**
- **Unplug the appliance when it is not in use, before cleaning it, and before fitting or removing parts and attachments.**

PLEASE RETAIN THESE INSTRUCTIONS

The De'Longhi blender, which combines professional function with practical use, will become an irreplaceable ally in your kitchen. It is:

- easy to use, thanks to the filler cap that allows you to introduce items while the blender is operating.
- ideal for instant recipes.
- irreplaceable for making quick, excellent water-ices..

INSTRUCTIONS FOR USE

WARNING

PREPARE THE CONTAINER WITH THE ITEMS TO BE BLENDED AND FIT IT TO THE MOTOR BODY BEFORE INSERTING THE PLUG.



Fig. 1



Fig. 2

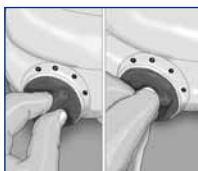

Fig. 3

- Lift the lid (B) (Fig. 1).
- Cut the food into small pieces and place it in the glass goblet (C); do not exceed the maximum level, which is marked on the container.
- Close the glass goblet (C) with the lid (B) (Fig. 2) and fit it onto the motor body.
- Insert the plug and turn the on control (F) clockwise to the first or second mark to start the blades (Fig. 3).
Turning the control (F) clockwise to the second mark will increase the speed of the blades (Fig. 3).
Turning the control (F) anticlockwise will activate the PULSE function (Fig. 4), very useful for short periods of processing. The appliance functions as long as is kept in the P position.
- **NEVER REMOVE THE LID DURING USE.**
- During use it is possible to add foods to the container by turning and lifting out the filler cap (A) (Fig. 5), after first switching off the appliance.
- It may become necessary to switch off the appliance several times in order to remove any food residues from the sides of the container. In this case, switch off the appliance and unplug the power cord.
- Remove the filler cap and lid and remove any residues from inside the container using a spatula.

WARNING

KEEP THE SPATULA AWAY FROM THE BLADE SET IN ORDER NOT TO DAMAGE THE BLADES AND THE SPATULA.

BLENDER DISASSEMBLY

- Remove the plug from the power socket before removing the glass goblet and blade assembly from the motor body.
- Release the glass goblet and blade assembly (C) by turning it anti-clockwise and remove it from the motor body (Fig. 6).
- Remove the lid and pour the blended contents into your glass or bowl.
- Lid (B), and filler cap (A) are dishwasher-safe.

CLEANING

Any dismantling of the appliance or any type of intervention inside it is strictly prohibited.

Keep the appliance clean and tidy to guarantee excellent results and a longer useful life.

- Before cleaning, switch off the appliance by setting the On/Speed control (F) so that it is completely vertical and unplug the power cord.

Do not place the motor body in water or other liquids.

Never use potentially abrasive products.

- Clean the blades with care.

WARNING

THE CUTTING EDGES OF THE BLADE ARE VERY SHARP.

- Always clean parts that have come into contact with food by hand in hot soapy water after use and use a brush for the blades.
- **Do not attempt to disassemble the blade unit from the glass goblet.**
- Always dry machine parts by hand - never place them in ovens or microwaves.



Fig. 4



Fig. 5



Fig. 6

The materials and the objects destined for contact with food products are in compliance with the regulations of the EEC directive 2004/1985.

IMPORTANT INFORMATION FOR CORRECT DISPOSAL OF THE PRODUCT IN ACCORDANCE WITH EC DIRECTIVE 2002/96/EC.



At the end of its working life, the product must not be disposed of as urban waste. It must be taken to a special local authority differentiated waste collection centre or to a dealer providing this service. Disposing of a household appliance separately avoids possible negative consequences for the environment and health deriving from inappropriate disposal and enables the constituent materials to be recovered to obtain significant savings in energy and resources. As a reminder of the need to dispose of household appliances separately, the product is marked with a crossed-out wheeled dustbin.

Warning
this appliance must be earthed

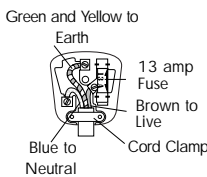

Electrical Requirements

Before using this appliance ensure that the voltage indicated on the product corresponds with the mains voltage in your home, if you are in any doubt about your supply contact your local electricity company.

The flexible mains lead is supplied connected to a B.S. 1363 fused plug having a fuse of 13 amp capacity. Should this plug become damaged it should be cut off and replaced with a suitable plug, following the procedure outlined below.

Note: Such a plug cannot be used for any other appliance and should therefore be properly disposed of, (having removed the fuse) and not left where children might find it and plug it into a supply socket - with the obvious consequent danger.

N.B. We recommend the use of good quality plugs and wall sockets that can be switched off when the machine is not in use.

Important: the wires in the mains lead fitted to this appliance are coloured in accordance with the following code:

GREEN AND YELLOW	EARTH
BLUE	NEUTRAL
BROWN	LIVE

As the colours of the wires in the mains lead of this appliance may not correspond with the coloured markings identifying the terminals in your plug, proceed as follows:

The wire which is coloured green and yellow must be connected to

the terminal in the plug which is marked with the letter **E** or by the earth symbol  or coloured green or green and yellow. The wire which is coloured blue must be connected to the terminal which is marked with the letter **N** or coloured black. The wire which is coloured brown must be connected to the terminal which is marked with the letter **L** or coloured red. When wiring the plug, ensure that all strands of wire are securely retained in each terminal. Do not forget to tighten the mains lead clamp on the plug. If your electricity supply point has only two pin socket outlets, or if you are in doubt, consult a qualified electrician. Should the mains lead ever require replacement, it is essential that this operation be carried out by a qualified electrician and should only be replaced with a flexible cord of the same size. If the plug is a moulded-on type the fuse cover must be refitted. If the fuse cover is lost, the plug must not be used until a replacement cover is obtained. The colour of the correct replacement fuse cover is that of the coloured insert in the base of the fuse recess or elsewhere on the plug. Always state this colour when ordering a replacement fuse cover. Only 13amp replacement fuses which are approved to B.S. 1362 should be fitted.

Service and Customer Care

- If the cord is damaged it must, for safety reasons, be replaced by DELONGHI or an authorised DELONGHI repairer.
 - UK
 - If you need help with:
 - using your kettle
 - servicing or repairs (in or out of guarantee)
- ☎ call DeLonghi Customer Care on 023 9239 2333. Have your model number ready - it is located on the underside of your kettle.
- spares and attachments
- ☎ call 0870 4296438.

COD. 6315101000

DeLonghi, New Lane, Havant, Hampshire PO9 2NH, UK
www.delonghi.com



Blender
KF8110J

Free Manuals Download Website

<http://myh66.com>

<http://usermanuals.us>

<http://www.somanuals.com>

<http://www.4manuals.cc>

<http://www.manual-lib.com>

<http://www.404manual.com>

<http://www.luxmanual.com>

<http://aubethermostatmanual.com>

Golf course search by state

<http://golfingnear.com>

Email search by domain

<http://emailbydomain.com>

Auto manuals search

<http://auto.somanuals.com>

TV manuals search

<http://tv.somanuals.com>