

CITRUS PRESS

KS3000M

Please retain these instructions for future use



Living innovation

Description of Appliance

The following terms are used throughout the instruction manual

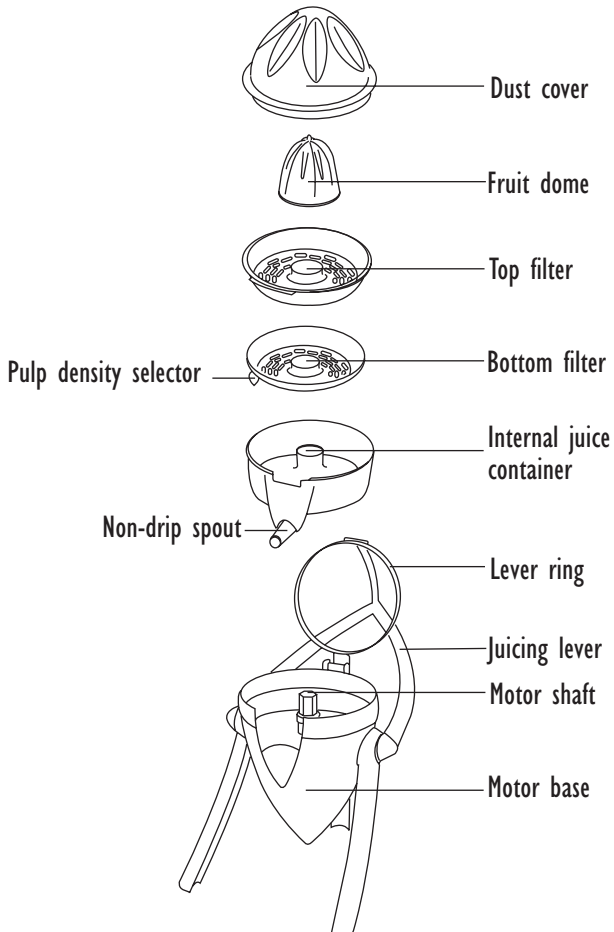

Thank you for choosing this De'Longhi citrus press. To get the best results from your new citrus press it is advisable to read these instructions carefully before using the appliance.

This is the only way to ensure optimum results and maximum safety.

Using for the first time

- Before use, check that the appliance has not been damaged during transport.
- Remove all packaging from the citrus press.
- Check that the voltage of the electrical socket corresponds to the voltage indicated on the label on the appliance. Before using the appliance for the first time, carefully wash and dry the fruit dome, filter, container and non-drip spout

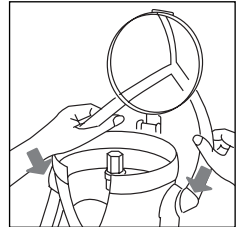

fig.1

Assembling the appliance

Assemble the appliance as follows:

1. Insert the two ends of the juicing lever into the guides (fig. 1).
2. Make sure the juicing lever is mounted correctly by raising and lowering the lever.
3. Insert the cover into the lever ring and push as far as it will go, making sure the tab on the ring fits into the hole in the cover (fig. 2).

At this point, the appliance is ready for juicing.

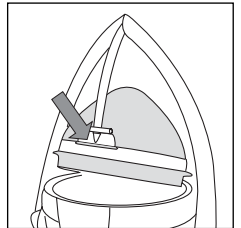

fig.2

Before use

Before using the machine for the first time, wash all the accessories (dust cover, fruit dome, top filter, bottom filter, pulp density selector, internal juice container, non-drip spout) in warm soapy water and rinse.

Use

- Place the container on the motor base.
- Fit the bottom filter and top filter.
- Place the filter assembly on the motor base, making sure the pulp density selector is positioned in the hollow in the motor base (fig. 3).
- Fit the fruit dome onto the motor shaft.
- Place a glass under the non-drip spout and move the spout downwards (fig. 4).
- Plug into the mains.
- Cut the citrus fruit in half.
- Place half a fruit onto the fruit dome and lower the cover by pushing the juicing lever down and pressing lightly. The motor is designed to rotate in either direction to optimise the juicing effect; press the juicing lever intermittently the motor will reverse its rotational direction.

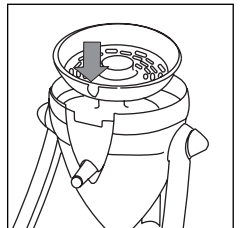

Fig.3

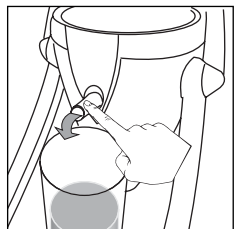

Fig.4

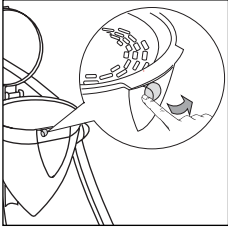

Fig.5

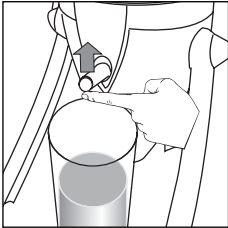

Fig.6

NB: the pulp density selector enables the quantity of pulp in the juice to be regulated by making the holes in the filter smaller or larger.

To reduce the amount of pulp, move the juice density selector left as far as it will go. To increase the quantity of pulp, move the selector to the opposite side (fig. 5).

Important: never use the appliance continuously for more than four minutes.

- When you have finished juicing, to reduce drips, move the non-drip spout to the raised position (fig. 6).

Cleaning and maintenance

- This appliance should not require any maintenance. However, before attempting to clean the appliance, unplug from the mains socket.
- Remove the filters, dome and juice container by pulling upwards.
- Remove all waste and clean the components.
- To avoid residues drying on, take the appliance to pieces and clean the components immediately after use.
- Wash the juice container, filters, cone and cover in warm water and detergent. None of the components can be washed in a dishwasher.
- Clean the motor base with a damp cloth.

NB: to facilitate cleaning, the non-drip spout can be removed from the container by rotating the spout outwards and pulling lightly; then replace.

Safety Warnings

Please read these instructions before operating and retain for future reference.

- After having removed the appliance from the packaging, make sure that it has all of its components. If there is any doubt, do not use the appliance and return it to be checked by qualified personnel.
- The plastic bag containing the appliance should be kept away from children as it may represent a suffocation hazard.
- In the case that the plug is not compatible with the electrical outlet being used, have it substituted with a suitable one by qualified personnel. The use of adapters, multi-way plugs, and/or extension cords is not recommended. Whenever their use might become necessary, use simple or multiple adapters and/or extension cords conforming to the safety laws, taking care to not exceed the power limits marked on the adapter or the extension cord.
- Should the appliance stop working, go to an authorised service centre.

- The appliance should be destined exclusively to the use for which it has been created. Any other use is to be considered inappropriate and therefore dangerous. The manufacturer cannot be held responsible for any damage caused by improper, erroneous or irresponsible use and/or by repairs made by unqualified personnel.
- Do not touch the appliance with wet or damp hands.
- Do not use the appliance with bare or wet feet.
- Do not unplug the appliance by pulling the plug out of the socket by the cord.
- Do not leave the appliance exposed to the atmosphere (rain, sun, freezing temperatures, etc.)
- Children or infirm persons should not be allowed to use this product unsupervised
- Remove the plug from the electrical socket when the appliance is not in use.
- Do not immerse the appliance in water.
- Before beginning any cleaning or maintenance procedures, disconnect the plug of the appliance from the electrical outlet.
- In case of malfunction and/or breakdown, turn the appliance off. For repairs, go to a qualified service centre requesting the use of original parts or accessories.
- Keep these instructions for further reference.
- If the supply cord is damaged, it must be replaced by the manufacturer, its service agent or similarly qualified persons in order to avoid a hazard.
- As with any electrical appliance, whilst the instructions aim to cover as many eventualities as possible caution and common sense should be applied when operating your appliance, particularly in the vicinity of young children.

The materials and the parts which come into contact with food products are in full compliance with the regulations of the EEC Directive 89/109.

Important information for correct disposal of the product in accordance with EC Directive 2002/96/EC.



At the end of its working life, the product must not be disposed of as urban waste. It must be taken to a special local authority differentiated waste collection centre or to a dealer providing this service.

Disposing of a household appliance separately avoids possible negative consequences for the environment and health deriving from inappropriate disposal and enables the constituent materials to be recovered to obtain significant savings in energy and resources. As a reminder of the need to dispose of household appliances separately, the product is marked with a crossed-out wheeled dustbin.

Warning

this appliance must be earthed

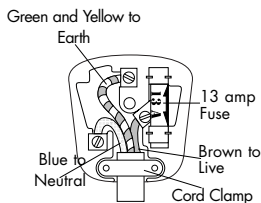

Electrical Requirements

The flexible mains lead is supplied connected to a B.S. 1363 fused plug having a fuse of 13 amp capacity. Should this plug not fit the socket outlets in your home, it should be cut off and replaced with a suitable plug, following the procedure outlined below.

Note: Such a plug cannot be used for any other appliance and should therefore be properly disposed of, (having removed the fuse) and not left where children might find it and plug it into a supply socket - with the obvious consequent danger.

If the plug is a moulded-on type the fuse cover must be refitted. If the fuse cover is lost, the plug must not be used until a replacement fuse cover is obtained. The colour of the correct replacement fuse cover is that of the coloured insert in the base of the fuse recess or elsewhere on the plug. Always state this colour when ordering a replacement fuse cover.

N.B. We recommend the use of good quality plugs and wall sockets that can be switched off when the machine is not in use.

important: the wires in the mains lead fitted to this appliance are coloured in accordance with the following code:

GREEN AND YELLOW	EARTH
BLUE	NEUTRAL
BROWN	LIVE

As the colours of the wires in the mains lead of this appliance may not correspond with the coloured markings identifying the terminals in your plug, proceed as follows:

The wire which is coloured green and yellow must be connected to the terminal in the plug which is marked with the letter **E** or by the earth symbol or coloured green or green and yellow.

The wire which is coloured blue must be connected to the terminal which is marked with the letter **N** or coloured black.

The wire which is coloured brown must be connected to the terminal which is marked with the letter **L** or coloured red.

When wiring the plug, ensure that all strands of wire are securely retained in each terminal. Do not forget to tighten the mains lead clamp on the plug. If your electricity supply point has only two pin socket outlets, or if you are in doubt, consult a qualified electrician.

Should the mains lead ever require replacement, it is essential that this operation be carried out by a qualified electrician and should only be replaced with a flexible cord of the same size. Only 13amp replacement fuses which are ASTA approved to B.S. 1362 should be fitted.

This appliance conforms to the Norms EN 55014 regarding the suppression of radio interference.

Free Manuals Download Website

<http://myh66.com>

<http://usermanuals.us>

<http://www.somanuals.com>

<http://www.4manuals.cc>

<http://www.manual-lib.com>

<http://www.404manual.com>

<http://www.luxmanual.com>

<http://aubethermostatmanual.com>

Golf course search by state

<http://golfingnear.com>

Email search by domain

<http://emailbydomain.com>

Auto manuals search

<http://auto.somanuals.com>

TV manuals search

<http://tv.somanuals.com>